





25 Headland Drive TURA BEACH NSW

4  3  4 

If you were looking for an excuse to move to Tura Beach, this is it. Located in prestigious Headland Drive, we offer 4 bedrooms, 3 bathrooms, upstairs and downstairs living, sporting a fresh inside and outside coat of paint and of course an uninterrupted ocean view. This home is big, big, big, but is designed to be snugly if you don't need all that space. Downstairs could be a teen or extended family retreat with living area, bathroom and 2 bedrooms. Upstairs features a roomy master with ensuite, 2nd bedroom & bathroom and expansive kitchen, dining and living areas. The outdoor areas impress with the front deck showcasing the views and the rear entertainment area leading to a generous back yard. The block is 969m2 in size and nice and level and has the added bonus of reserve to the side and battleaxe driveway on the other side, that's privacy

Type : House

View : <https://www.butterfieldproperty.com.au/sale/nsw/far-south-coast/tura-beach/residential/house/8151079>

[For full version visit the website](https://www.butterfieldproperty.com.au)

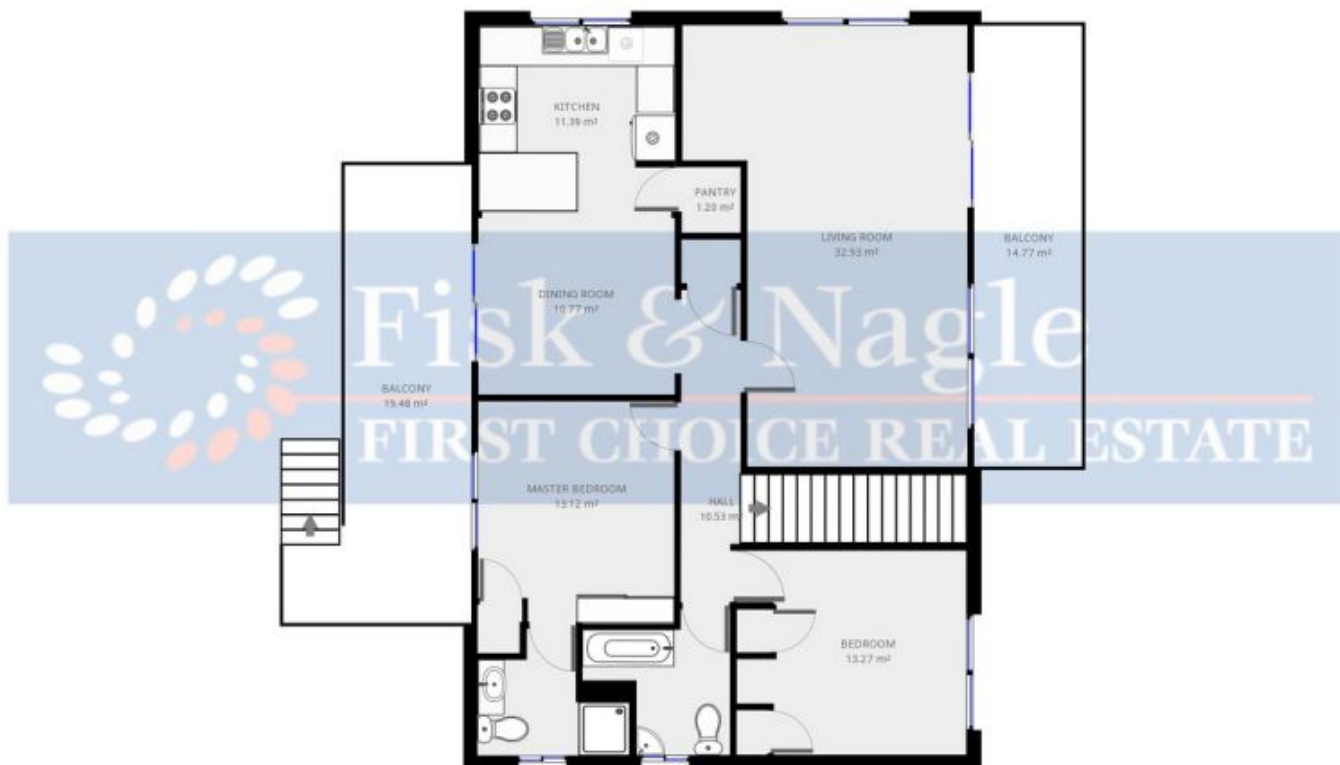

Disclaimer: Please note this floor plan is for marketing purposes and is to be used only as a guide to the layout of the property.



Fisk & Nagle
FIRST CHOICE REAL ESTATE



Disclaimer: Please note this floor plan is for marketing purposes and is to be used only as a guide to the layout of the property.