



443 Kameruka Lane TOOTHPALE NSW

4  4  2 

Centrally located between Bega and Merimbula, this large home with two living areas is ideal for a growing family, or could be re-established as a Bed and Breakfast for some extra cash!

Type : Rural
Land Size : 20234.3 sqm
View : <https://www.butterfieldproperty.com.au/sale/nsw/far-south-coast/toothdale/residential/rural/8150983>

- 4 bedrooms, 4 ensuites
- Back-to-grid solar power
- Large modern kitchen
- Self-contained studio
- Double carport and workshop
- Sunny verandah with wheelchair access
- 4 chook houses
- Large veggie garden and established orchard
- 138000L water tank and dam
- 5 acres with stunning views

97.1155

7 July 1997

M. J. ...

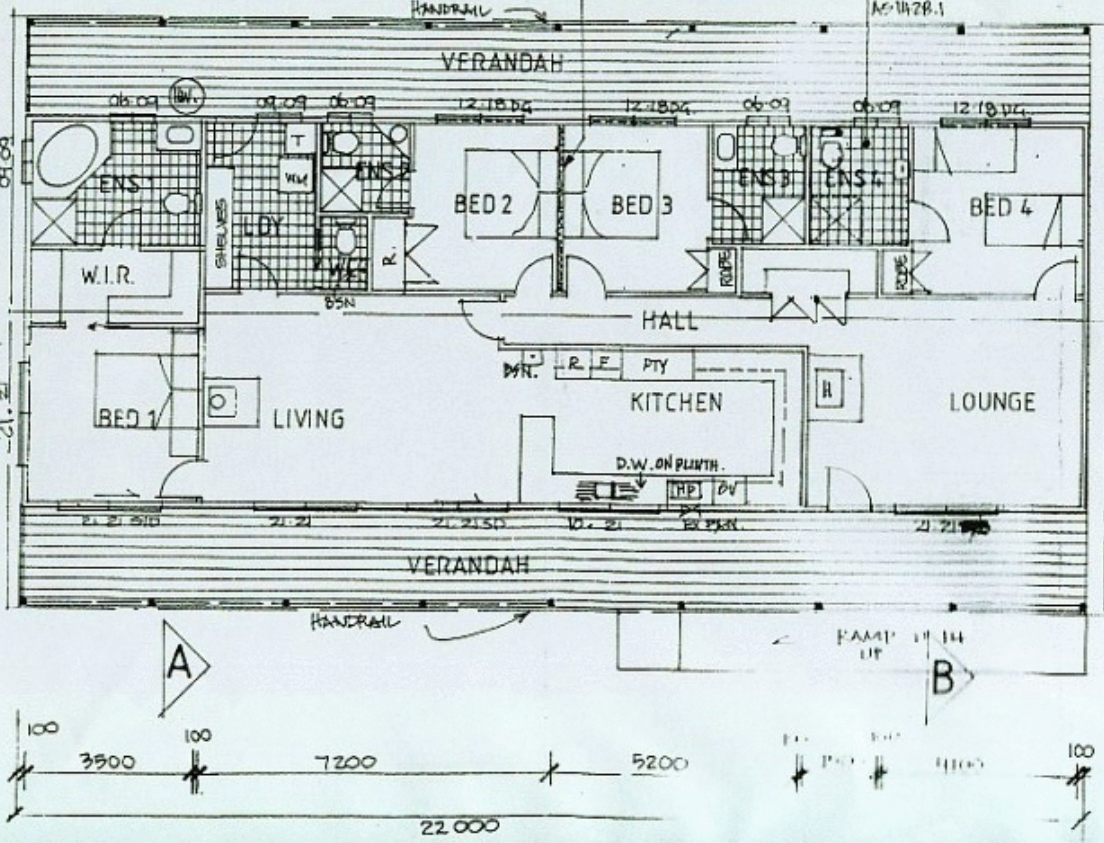

SCHEI

AREA: 176m ² O.A.
L.F. 24m ² C.A.R.
G.P.O. 24