



8 Bellbird Court Wolumla NSW

4  2  4 

On half an acre of land backing on to what feels like your own private rainforest this home gives you that peaceful, relaxing feel as soon as you enter.

Featuring 4 bedrooms, all with built in robes main with ensuite and walk in robe. Modern open plan entertainers kitchen / dining leading out to a covered outdoor patio that looks out over the beautifully managed garden area that gives you privacy and serenity. Teenagers retreat/rumpus room downstairs, double lock up garage for secure parking.

Bega & Merimbula both within approx 15kms of the town of Wolumla it is perfect for the whole family or anyone wanting to escape the hustle & bustle.

Dreaming of owning your own piece of paradise? You need to see this property!

Type : House
Land Size : 2162 sqm
View : <https://www.butterfieldproperty.com.au/sale/nsw/far-south-coast/wolumla/residential/house/8150854>



Elvi Di Donato
0427 953 002



This plan is intended for marketing purposes only. All measurements are approximations.

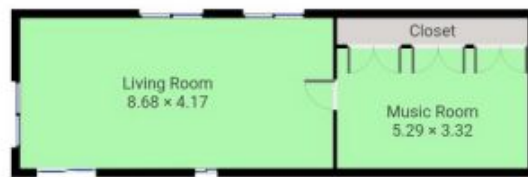

This plan is intended for marketing purposes only. All measurements are approximations.