





15 Bleakley Street Bermagui NSW

4  2  4 

Positioned on a flat and secure 836 sqm parcel of land in a quiet and convenient part of town, this 2-story home is ready for its new owner to make their own. With a flexible floor plan and options for accommodation on either level, there is plenty of room for the whole family. Features include:

- 4 bright bedrooms with built in robes.
- 2 bathrooms (1 on each level)
- Open plan living/dining area opening onto the enclosed verandah.
- Original but well-maintained kitchen.
- Large double garage with drive through access to the rear yard.

Lifestyle wise, this property is very close to both the golf course and the dog friendly Beares Beach. A great

Land Size : 836 sqm
View : <https://www.butterfieldproperty.com.au/sale/nsw/eurobodalla-coast/bermagui/residential/house/7336815>



Mick Butterfield
(02) 6493 3444



Melisa Ashton
(02) 6493 3444

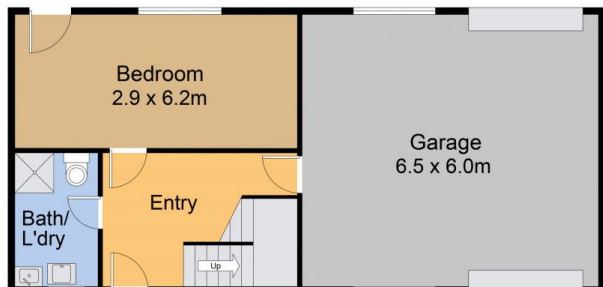

Lower Level



Upper Level



15 Bleakley Street, Bermagui



Plan is not to scale. Measurements are approximate and should be used as a guide only.